

CENTRE COURT SHOPPING CENTRE

Queens Rd, Wimbledon, SW19

AREA PLAN

Revisions:

A - Original Issue (June 2019)

B -

C -

D -

E -

F -

Unit 114 - Mezzanine Area Plan

This Drawing is indicative of the area measured - **Not to Scale**

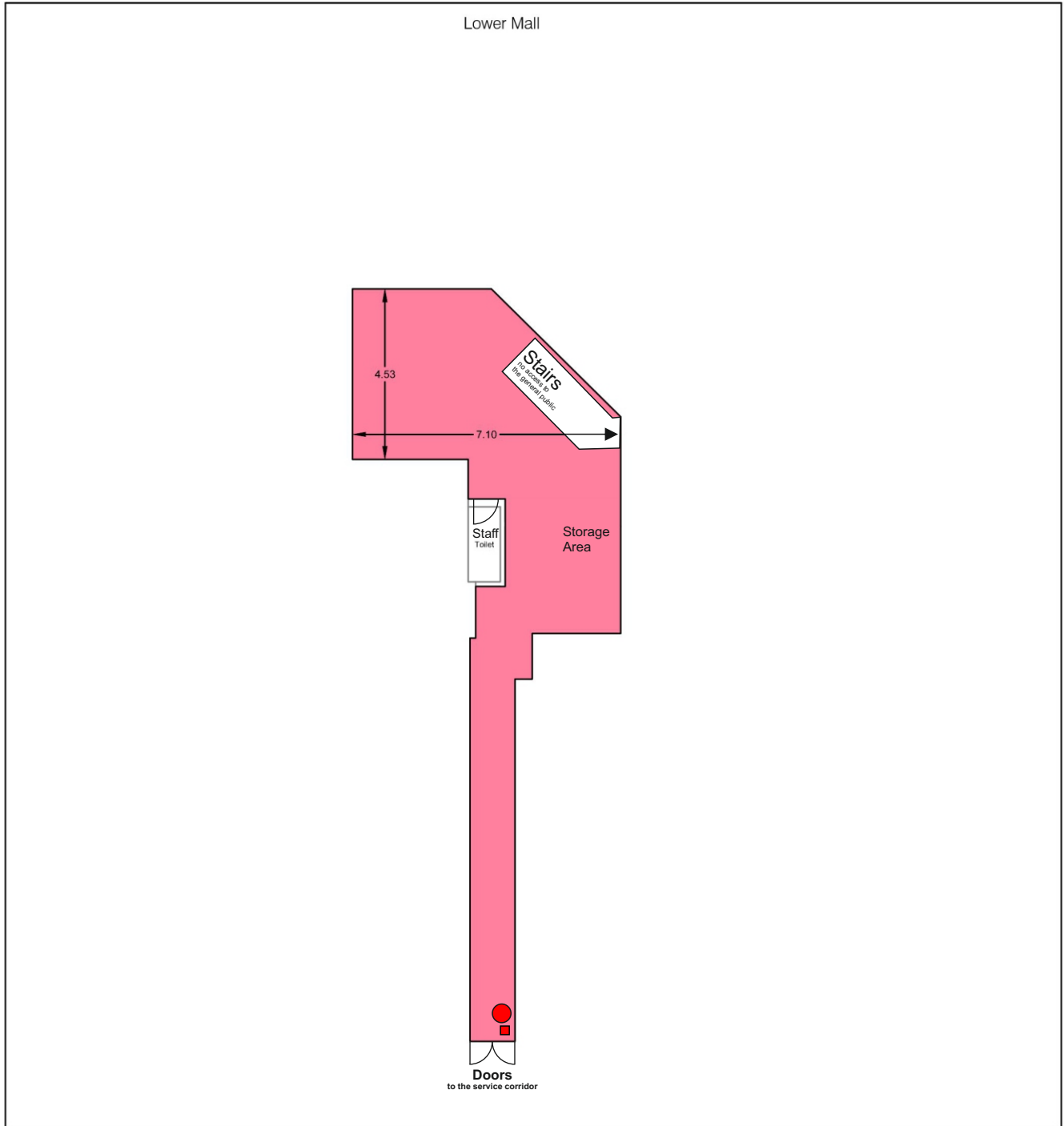

 NIA - Retail 56.0 sq m 603 sq ft

 fire extinguisher

 break glass alarm

TOTAL NIA: 56.0 sq m 603 sq ft

Drawing Number
LF2222-AREA-U114-01

Issue A
June 2019

Lane &
Frankham



Page 31

info@laneandfrankham.com / +44(0)20 3714 7063 / www.laneandfrankham.com

This page is intentionally left blank